

# Progressive Distributor - TSPV

## Technical Data Sheet

### Product Description

The TriboServ progressive distributors (TSPV) are designed to supply with oil or grease to multiple lubrication points in various processing systems and machines.

Lubricant that is supplied by a lubricant pump is proportionately divided in subsets according to dosing elements and number of outlets. It is then progressively delivered to the lubrication points.

The number of outlets, delivery rates and arrangements of the lubricant outlets are configured by design for the TSPV standard distributors described below. On request, various special configuration distributors are also available.

The TSPV is a progressive lubricant distributor with a maximum working pressure of 100bar.

It is suitable for use with the Tribo-Serv FlexxPump series. Consult your Tribo-Serv supplier for use with another pump unit.

### Intended Use

Distribution of oil or grease.

### Technical Data

Inlet Connections		Straight or Elbow
Inlet Tube Diameter		4mm / 6mm / 8mm
Number of Segments	min	3 Segments
	max	7 Segments
Number of Outlets		Up to 14 Outlets
Maximum Back Pressure		100 Bar (1450 psi)
Operating Temperature		-20°C, 70°C (-4°F, 158°F)
Lubricants	Grease	up to NLGI Class 2
	Oil	up to 30,000 cSt at 40°C
Maximum Inlet Volume		0.05ml/s (0.0017oz/s)
Outlet Connections		Diameter 4mm Diameter 6mm
Material		Aluminum
Mounting Position		Dosing Elements Horizontal to Ground Level

### Important instructions

For accurate dispensing, delivery pistons of TSPV make at least two complete cycles during each lubrication process.

When using the TSPV with the lubrication pumps of the TriboServ FlexxPump series, it is therefore recommended to either program the TriboServ FlexxPump or to control it from the connected PLC in such a way that the number of delivery cycles mentioned in the following table are executed.

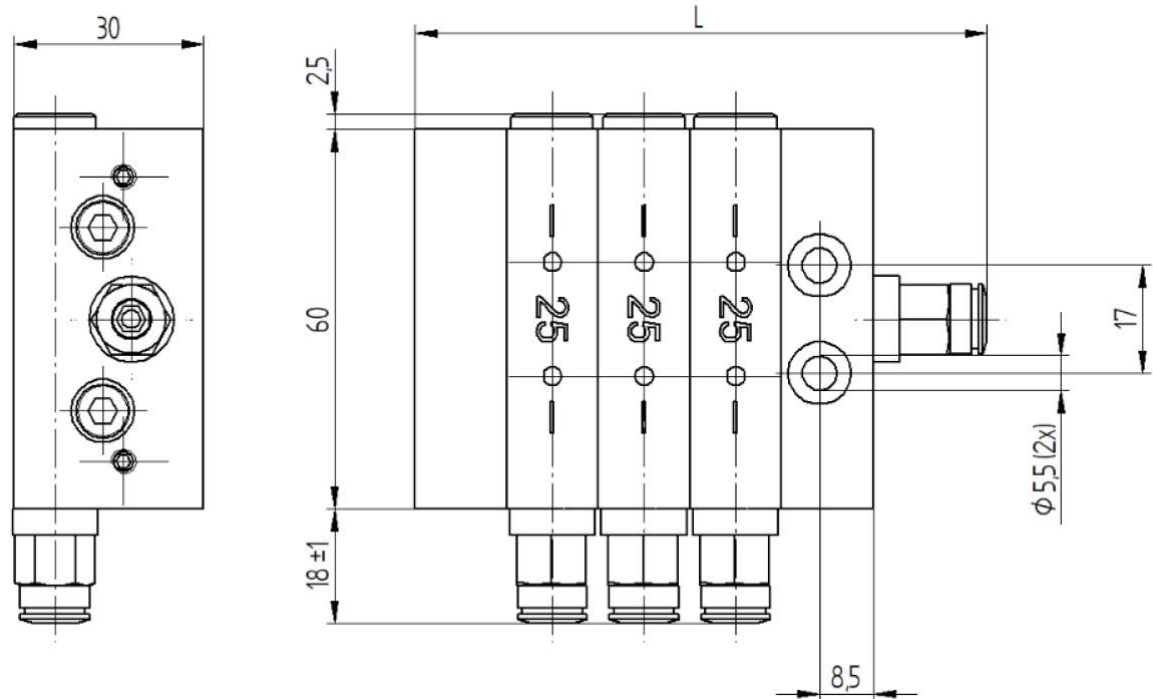

Figure 1: TriboServ Progressive Distributor (5 Dosing Elements and 9 Outlets)



Figure 2: TSPV with Cycle Monitoring Switch (4 Dosing Elements and 8 Equal Outlets)

## Dimensions



**3 Segment Progressive Distributor Block**

**L: 92.42mm (3.639")**

**4 Segment Progressive Distributor Block**

**L: 106.67mm (4.199")**

**5 Segment Progressive Distributor Block**

**L: 120.97mm (4.763")**

**6 Segment Progressive Distributor Block**

**L: 135.32mm (5.328")**

**7 Segment Progressive Distributor Block**

**L: 149.70mm (5.894")**

Dispensing Elements	Delivery per Piston Stroke
Dispensing Element 25	0.025ml (0.0009oz)
Dispensing Element 50	0.050ml (0.0017oz)
Dispensing Element 100	0.100ml (0.0034oz)



Please visit [www.triboserv.com](http://www.triboserv.com) for available Accessories

The above data and information correspond to the current state of our knowledge and development. However, they do not represent an assurance of properties or a guarantee for the suitability of the products in individual cases. We reserve the right to change the information in this technical data sheet or to make technical changes at any time and without prior notice. The representation on the pictures may differ from the original.

**TriboServ**

**SpectroLube Inc.**  
President: Aykut Ozdemir

2212 Silverbirch Court  
L7M 3H4 Burlington, Ontario  
Canada

Phone: +1 (647) 278-4366  
Mail: [aykut.ozdemir@spectrolube.com](mailto:aykut.ozdemir@spectrolube.com)  
Web: [www.spectrolube.com](http://www.spectrolube.com)



**Quality Management**

We are certified.

ISO 9001:2015

EN  
Version: 1.0  
Page 2 of 2